

PRATT COMMUNITY COLLEGE

**RESIDENCE LIFE
+ STUDENT LIFE**

HOME *of*
THE BEAVERS



PRATT 
Community College

WELCOME
home
Beavers



PRATT COMMUNITY COLLEGE
RESIDENCE LIFE



FROM THE DIRECTOR

Welcome to Pratt Community College and living on campus! The goal of the Residence Life program is to provide a safe environment for our students where they can build long lasting relationships and grow as individuals. We encourage students to take advantage of our numerous activities and opportunities to make the most out of the residence life experience.

Please take the time to meet your Resident Assistants (RA's) and Residential Supervisor. These leaders are there to help you succeed on campus. They will provide opportunities to get involved in your residence hall and community throughout the semester. Each day there is an adult Residential Supervisor on duty. They are our professional staff members on call 24 hours a day to answer any questions and help with residence hall needs.

PRATT COMMUNITY COLLEGE MISSION STATEMENT

The mission of Pratt Community College is maximum student learning, individual and workforce development, high quality instruction and service and community enrichment.

RESIDENCE LIFE DEPARTMENT MISSION STATEMENT

The mission of Residence Life is to provide residence hall students with important learning and living experiences, which allows for positive growth intellectually, culturally, and socially within a safe environment.

CONNECT WITH US



Pratt Community College
Student Life



@pccstudentlife



residencelife@prattcc.edu



prattcc.edu/residencelife

Move-In Day

Residence Hall Move-In Information

Residence hall move-in day will be conducted on the Sunday before the start of Fall semester classes.

Be Prepared

1. Submit Application for Admission to PCC online via Self-Service
2. Submit Housing Contract
 - Contract will be available by February 1st
 - Hall assignments are made on a first-come, first-serve basis
3. Official communication will be sent from the Residence Life Director concerning next steps, any additional required documentation and what/what not to pack.
4. Official hall assignments are made in July. Notifications will be sent to students via email.
5. Mark your calendars: residence hall move-in will be conducted on the Sunday before the start of Fall semester classes.

Accommodations

The **Student Success Center** is your first point of contact when requesting accommodation services from Pratt CC.

"We will process and review all requests for academic accommodations and liaison with faculty to ensure they are aware of any student academic accommodations. We provide clinical mental health services and outreach to support Pratt CC students. Our services are free of charge, if you are needing someone to talk please reach out to us!"

Student Success Center ssc@prattcc.edu
Beaver Dome, Room 55 **620-450-2156**

- Student Success Director



Student Testimonials

Why do you like living in the Residence Halls at PCC?

"For me I love being close to everything & it really helps you make tons of friends. It is also a great way to feel more at home especially since you get to customize the space in which you live in."

-Bryanna Gallagher
Amarillo, Texas



"I like it because it shows lots of diversity and shows the opportunity of relations you can make with the other students and the dorm parents."

-Apostolo Zuniga
Topeka, Kansas



"I like that I can be closer to all the campus activities. It makes it easier to get to and from class and practice. I also get to be with all my friends."

-Madison Bergkamp
Meade, Kansas



"I love sharing and learning different cultures. Meeting new people."

-Bobby Williams
Casselberry, FL



"It's like a never ending sleepover with all my homies."

-Samuel Kelly
Wichita, Kansas



Resident Assistants (RA's)



The Resident Assistants (RA's) at Pratt Community College are students that help their peers transition to college life.

They live in the halls with fellow students and apply and interview for the position as a regular paid job. RA's receive extensive training in multiple health, safety, emergency, mental health and social issues to fulfill their duties. It is a big responsibility.

Resident Assistants strengthen their communication, conflict resolution and leadership skills throughout the year. They commit to an on-duty schedule planned around busy academic and athletic schedules to serve their peers.

Together with the Residence Life team, they help form the backbone of the close-knit Residence Life community at Pratt CC.

✓ The Student Life Department is here to encourage involvement in campus life, and support student initiatives.



✓ Education happens inside and outside the classroom, and a successful college career includes social as well as intellectual development.



✓ Invest in your own success and get involved with Student Life and Student Activities at Pratt CC!

FAQs

Move-In & Living On Campus

Frequently Asked Questions



WHAT SHOULD I DO IF I WANT TO CANCEL MY APPLICATION?

You may cancel the housing contract by giving written notice to the Director of Students & Residence Life. A penalty may be assessed as indicated on contract. Pratt CC reserves the right to cancel the contract. Any refunds of payments will be made in accordance with the provisions of the contract.



WHAT SHOULD I DO IF I WANT TO CHANGE ROOMS?

You will have the opportunity to request a room change three times in the fall (Week 3, Week 8, Finals Week), and twice in the spring semester (Week 3, Week 8).

HOW DO I GET MORE INVOLVED ON CAMPUS?

Pratt CC is proud to offer many diverse involvement opportunities in several student organizations. The Student Life department also plans a variety of activities for students to enjoy. For a full list of student organization and contact information visit: <http://prattcc.edu/student-life/clubs-and-organizations>.



WHAT ABOUT SAFETY AND SECURITY?

Key card access is required for all residence halls. There is an adult residential supervisor on duty 24 hours a day. Campus security contact information and emergency procedures are posted in residence halls and designated areas in every building on campus. All resident assistants and residential supervisors attend required trainings for safety and procedures.

DO I NEED A PARKING PASS?

Parking on campus is free and plentiful. Specially designated parking places are marked with signage. No parking pass is required to park on campus. View a campus map and further parking information at the back of this booklet!



WILL I HAVE ACCESS TO WI-FI IN MY DORM ROOM?

Login: Use Pratt CC Student Wifi (not Guest)
Use your Pratt CC Email as your Username
and password to log in.

If you have issues, try typing in pccw.prattcc.edu
If issues still proceed, submit an IT Help Request in
E-central. Additionally, there are ethernet ports in each
room for game systems and computers.

WHAT IS PCC'S LIABILITY POLICY?

Full disclosure of Pratt CC's liability policy can be found
within the Housing Contract. All residence life questions
should be directed to: residencelife@prattcc.edu

WHAT IS MY MAILING ADDRESS ON CAMPUS?

You will be assigned a mail box in the upper commons
area of the main building. Mail will be distributed once
daily when it arrives. There is a postal box outside the
mail area where outgoing mail is picked up daily. You
are required to regularly check your mail and are re-
sponsible for the content. An ID is required to pick up
boxes. Mail should be addressed:

Name
Box # (not room number)
Pratt Community College
348 NE SR 61
Pratt, KS 67124

WHAT ARE COLLEGE HEALTH HOURS AND SERVICES?

College Health is located in the Riney Student Conference
Center, Room 303 near the bookstore.

Hours:
Monday - Thursday: 8:30 a.m. - 3 p.m.
Friday: 8:30 - 12:30 p.m.

*Services include: blood pressure checks, over the counter meds, referrals,
care of minor cuts/wounds, etc. and treatment of: sinus infection, urinary
tract infection, ear infection, seasonal allergies, sore throat, skin infection,
etc. Information is subject to change.*

WHAT ARE CAFETERIA HOURS AND PLANS?

PCC offers meal plans of 10, 14 and 19 meals per week.
Plans are at your convenience. The Great Western Dining
hall serves 3 meals per day Monday through Friday, and 2
meals a day (brunch/dinner) on weekends.



Residence Halls

North Hall

North Hall was built in 1998. This co-ed facility houses 64 people. This suite-style residence hall pairs two rooms with a private bathroom in between, and there are eight single rooms in this building as well. North Hall also has disability-accessible rooms. The lobby features computers, a large TV, and study area. The second floor lounge has a study area as well.

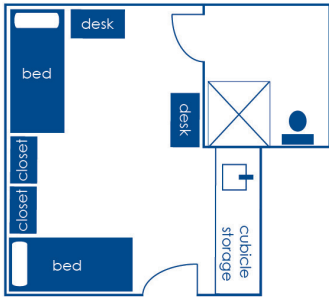

Scholarship Hall

Scholarship Hall was completed in 2002 and houses 72 students. This facility is also co-ed with the suite-style layout. Much like North Hall, the lobby features computers, a TV and a study area. The second floor lobby is home to an additional recreation and study area. In addition to adjoining room bathroom facilities, a private bathroom is available in the common area.

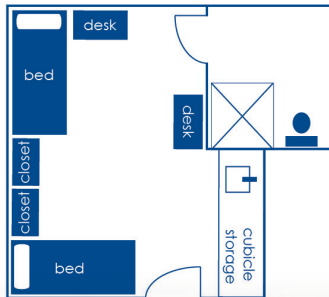

Each building has its own laundry facility

Novotny Hall

Novotny Hall houses 96 men and is the largest residence hall on campus. Novotny is a pod-style building with several rooms sharing bathrooms that connect the east and west wings. A recreation room in the basement serves as a study area, with a television.

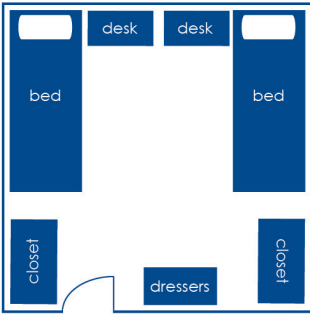

Wojciechowski Hall

Wojciechowski Hall is Pratt CC's newest residence hall, completed in 2010. This facility is co-ed and offers apartment-style living amenities for 72 students. Each suite features two bedrooms with twin extra-long beds a desk, dresser and closet per student plus a bathroom, kitchen and living room per apartment. A private bathroom is available in the common area.

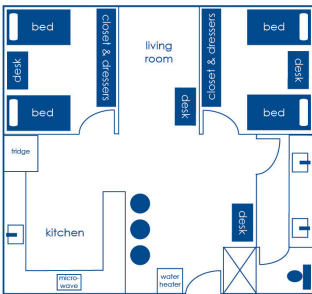

Beck Hall

Beck Hall was built in 1986 and houses 36 women. It is a community-style facility with two people per room and one large bathroom is shared per wing. The lobby area features a kitchenette, couches, big screen TV, computers and study areas.

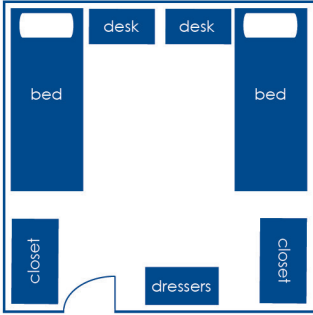

Porter Hall

Porter Hall was built in 1983 and houses 16 students. This facility is designed much like Beck Hall with a pod-style layout. The lobby area features a recreation and study area with a TV and computers.

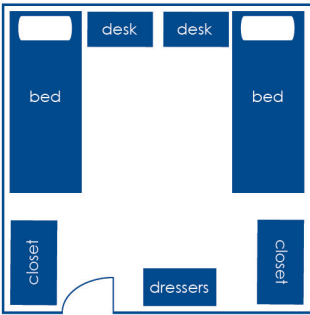

Upgrades to the Porter Hall took lobby place in 2023, which included gaming tables, a beverage machine, gaming system and television.



What To Bring

What You May Need:

Bedding

- Blankets, bedspread, pillows
- Sheets for Twin XL
- Mattress cover

Personal Items

- Shower tote caddy/bucket
- Towels, washcloths, bathrobe
- Clothing (all weather)
- Laundry detergent, basket or bag
- Personal grooming items
- Toiletries
- Health insurance card
- Medications

Room Extras

- Curtains (all windows have blinds)
- Clothes hangers
- Dishes, cups, utensils
- Wastebasket
- Cleaning supplies
- Backpack
- Pens, pencils, paper

Other Items to Consider

- Laptop computer
- Personal electronics
- Desk or floor lamps
- Microwave
- Mini fridge (less than 5 cu ft)
- Bicycle and U-lock
- Surge protectors
- Rug
- Posters
- Cards/Games

No... but

- No candles/wax warmers, plug-in air fresheners... but you can have an oil diffuser.
- No extension cords... but you can have surge protectors.
- No nails, screws, command strips... but you can use blue painter's tape.
- No window air conditioners, space heaters... but you can have an electric fan.
- No pets... but you can have a fish in less than 5 gallons of water.



Your First Weeks

New Student Information Session (NSIS)

New students are organized in small groups with other incoming students, a Pratt CC faculty member, staff member and a Resident Assistant for an orientation event.

Fun games, food and campus swag will help you get to know other students, learn campus FAQs and leave plenty of opportunity to win great prizes. It's a popular event you don't want to miss!



Welcome Week

Pratt CC's Student Life department has activities ready and waiting every night of Welcome Week to help you settle in and find your people!

Activity Calendars are provided to every student upon arrival for Welcome Week and every month following with a variety of activities planned for the entire academic year.

Join in on the activities and enjoy the full college experience!

Important Dates/Breaks

Spring Break - Second full week of March

Fall Break - Second Monday in October

Thanksgiving Break - The Wednesday before and the Friday after the Thanksgiving holiday.

Winter Break - Residence halls close the Friday following final exams and reopen two days before Spring classes begin.

**Students have access to Pratt CC's website, social media channels and official calendars listing this information in advance and will receive internal messaging in the event of any changes.*

KNOW WHERE TO GO

Campus Map & Parking

Parking lots are provided for each residence hall. Anyone who drives an automobile must adhere to campus regulations governing such vehicles. It is the duty of the student to acquaint themselves with all campus regulations for vehicles. Bicycles, motorcycles, or vehicles of any kind are not to be used on the sidewalks, or grass area of campus. At no time are cars to be parked on the grounds around the residence halls. Vehicles that are parked in designated handicapped areas without proper identification may be towed at the owner's expense.

Parking in an assigned space will result in a \$35 fine. Pratt Community College is subject to the rules and regulations of the city of Pratt as well as the campus security. Vehicles must be properly licensed and insured to be located or driven on campus.

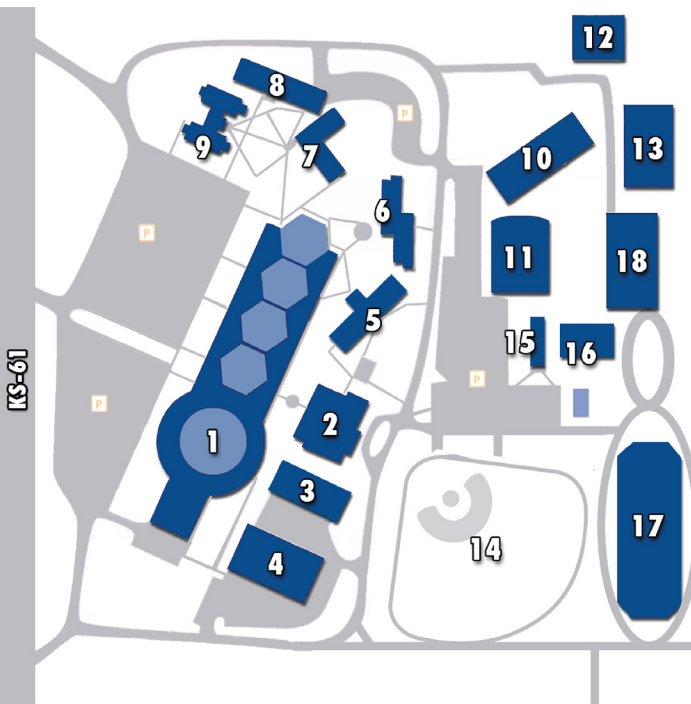

PRATT

Community College

348 NE SR 61 Pratt, KS 67124

www.prattcc.edu 620-672-5641

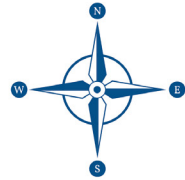

- | | | | |
|--|------------------------|--------------------------------------|---|
| 1. Benson Education Building (0-99) | 5. Scholarship Hall | 11. Chandler Hall | 15. Stanion Indoor Practice Facility |
| 2. Riney Student Conference Center (300's) | 6. Beck Hall | 12. Electrical Power Center | 16. Softball Practice Facility |
| 3. Ag Power Building (200's) | 7. Porter Hall | 13. Electrical Power Technology Barn | 17. Huffman Arena |
| 4. Gwaltney Hall (100's) | 8. North Hall | 14. Stanion Baseball Field | 18. Agricultural Activities Center |
| | 9. Novotny Hall | | 19. Track & Soccer Complex (not pictured) |
| | 10. Wojciechowski Hall | | |

